

Express & Solution Pump Parts Guide

Dedication builds precision

Trust matters. For over 70 years, our holding and dispensing equipment has been designed

to impress and engineered to last. Shipped undamaged and in working order. Guaranteed.

Parts & Service

| 81



Pump Parts | 88

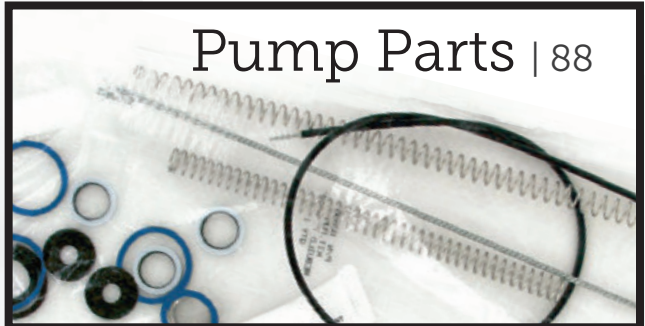

**How
to
Buy**



Visit server-products.com



Consult your rep or find a dealer



Get in touch

Parts & Service

Server Products equipment is sold through a large network of dealers, with list prices in this book as a reference point. For competitive net pricing, contact your local dealer/distributor or visit server-products.com/How-to-Buy to locate a dealer.

2 YEAR WARRANTY

All Server products are backed by a two-year warranty.

- Covers defects in materials and workmanship
- Excludes replacement of wear parts like o-rings, seals and springs
- Call 800.558.8722 for a Return Material Authorization Number
- Repairs are performed at our manufacturing facility in Richfield, Wisconsin
- You cover return freight costs to Server Products for evaluation
- If under warranty, your repaired unit is returned at no charge to you via ground
- 48-hour turnaround (from receipt) is common
- Please note: we operate on a five-day work week
- A complete warranty statement is available at server-products.com/Parts-Service

Returns for Credit

- Need to occur within 90 days of purchase
- Must be in new and unused condition
- For safety reasons, electrical components (heating elements, thermostats, etc.) are not returnable
- A standard restocking fee of 20% applies
- Call 800.558.8722 for a Return Material Authorization Number

Return Shipping Information

- Packaging is important – Server is not responsible for equipment damaged in shipping
- Items should not be returned without a Return Material Authorization Number (RMA #)
- To ensure timely processing, please put your RMA # on the box and ship to:

C/O Repair Department RMA # _____
 Server Products, Inc.
 3601 Pleasant Hill Road
 Richfield, WI 53076

Equipment & Parts Purchasing

- Please choose carefully. For safety reasons, electrical components are not returnable
- Purchase through your dealer
- Prices are FOB Richfield, WI 53076 – shipping charges not included

Equipment & Parts Assistance

- Contact our customer service team at: 800.558.8722 (M-F 8:00 am to 4:30 pm CDT)
- Live chat available at server-products.com during business hours
- Please know your Part Number, Model and Series information located on the lid for pumps or the bottom of heated and countertop units

Parts & Price Guide

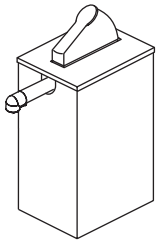

Example Unit

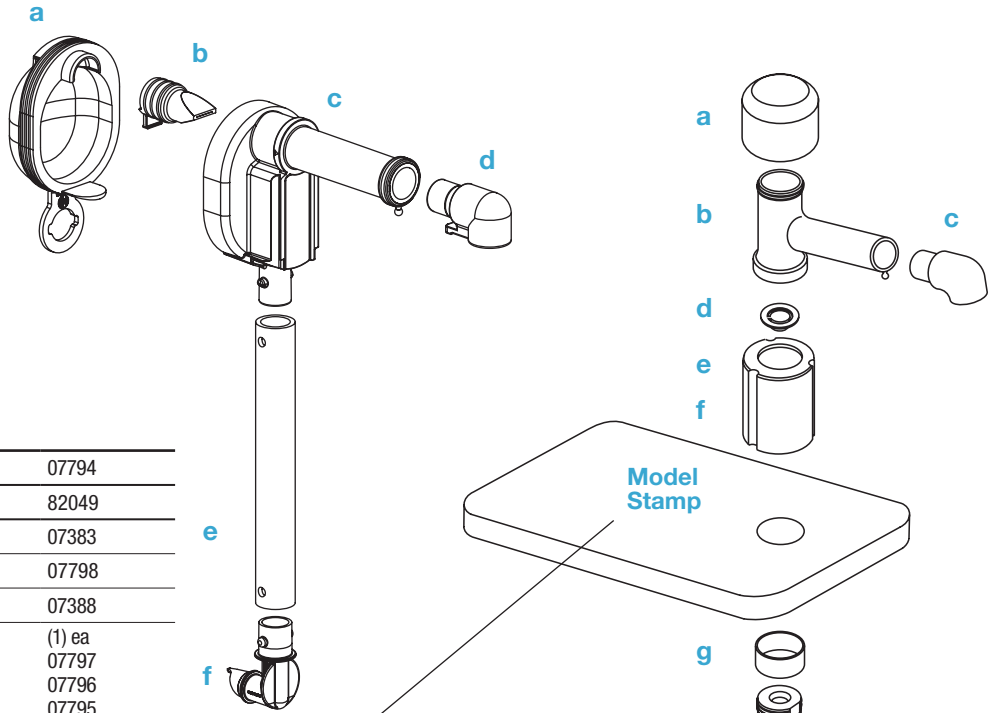

Express™ Style Pumps

Complete Spare/Repl. Pump	07794
Cleaning Brush, 1 1/4" Dia.	82049
a Dome, Black	07383
b Pinch Valve	07798
c Pump Housing	07388
d Discharge Fittings:	(1) ea
.394" (large opening)	07797
.256" (medium opening)	07796
.156" (small opening)	07795
e Silicone Tube	07089
f Connector, 16 mm	07381

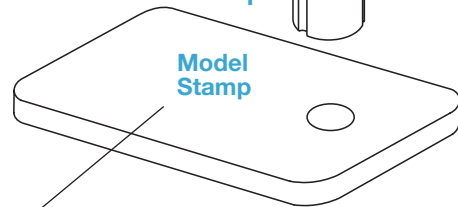

Model Stamp

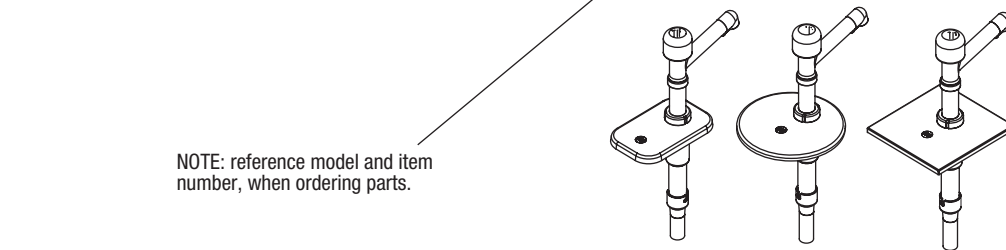

NOTE: reference model and item number, when ordering parts.

Not all pump styles are pictured.

Solution™ Style Pumps

Cleaning Brush, 1 1/4" Dia.	82049	Food Equipment Lubricant, 1/4 oz	40179
Cleaning Brush, 21" Long	82526		
a Knob	85301	i Seal	85315
b Discharge Tube	85313	j Spring	85314
c Discharge Fittings:	(1) ea	k Cylinder For All Except:	85307
.394" (large opening)	85304	83190, 83210, 83340 & 84060	
.256" (medium opening)	85302	Cylinder For:	85308
.156" (small opening)	85303	83190, 83210, 83340 & 84060	
d Ball Valves	(2) 85305	l Connector	85306
e Locking Collar For All Except:	85311	m Suction Tube For All Except:	85319
83190, 83210, 83340 & 84060		82020, 83190, 83210 & 83340	
f Locking Collar For:	85312		
83190, 83210, 83340 & 84060			
f Lid (See Parts Breakdown at server-products.com)			
g Portion Reduction Collar, 1/4 oz	85316		
h Piston	85309		

